

DETALHE - SINALIZAÇÃO RAMPA DE ACESSIBILIDADE

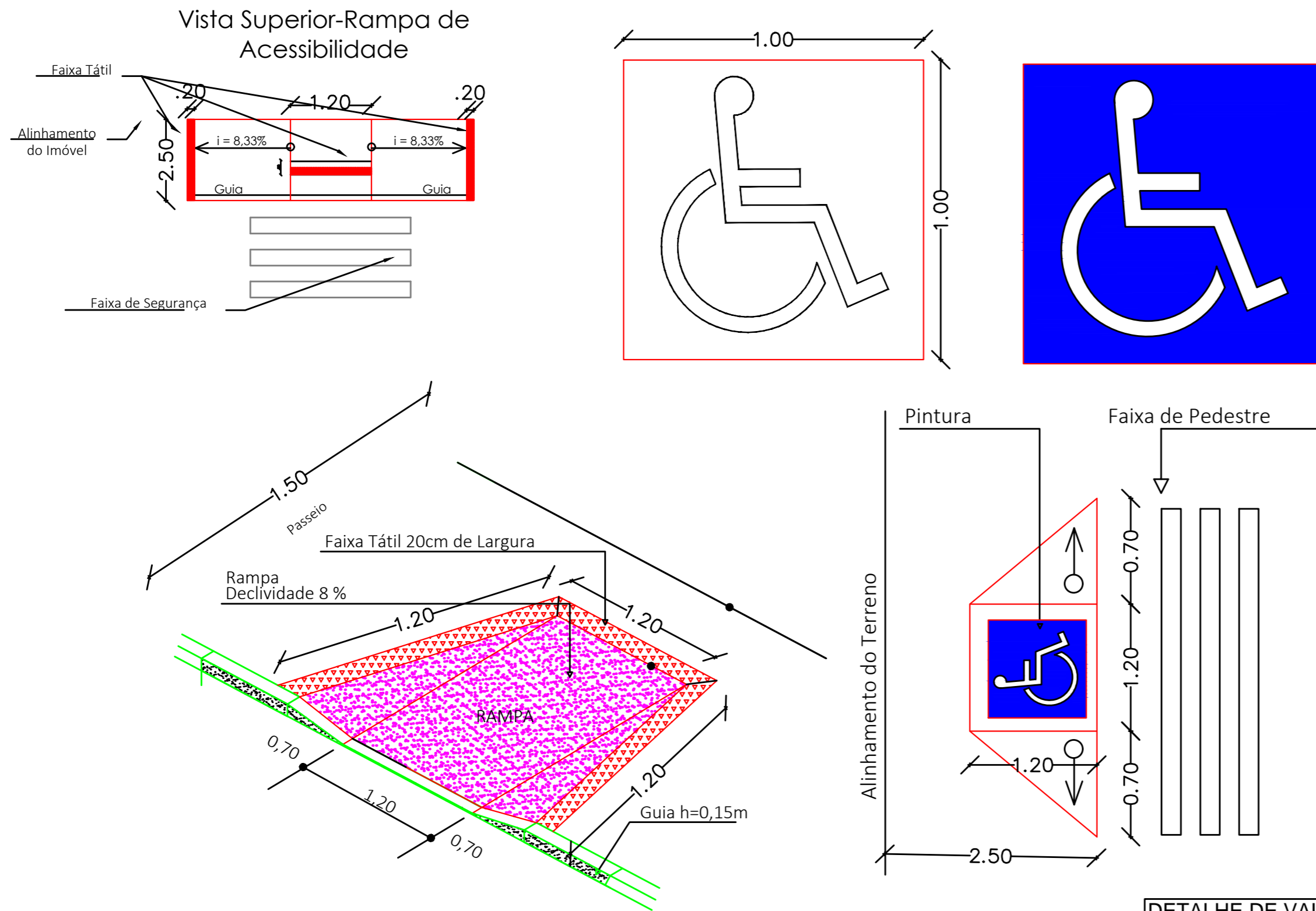

DETALHAMENTO DE SINALIZAÇÃO VERTICAL EM ZONA URBANA

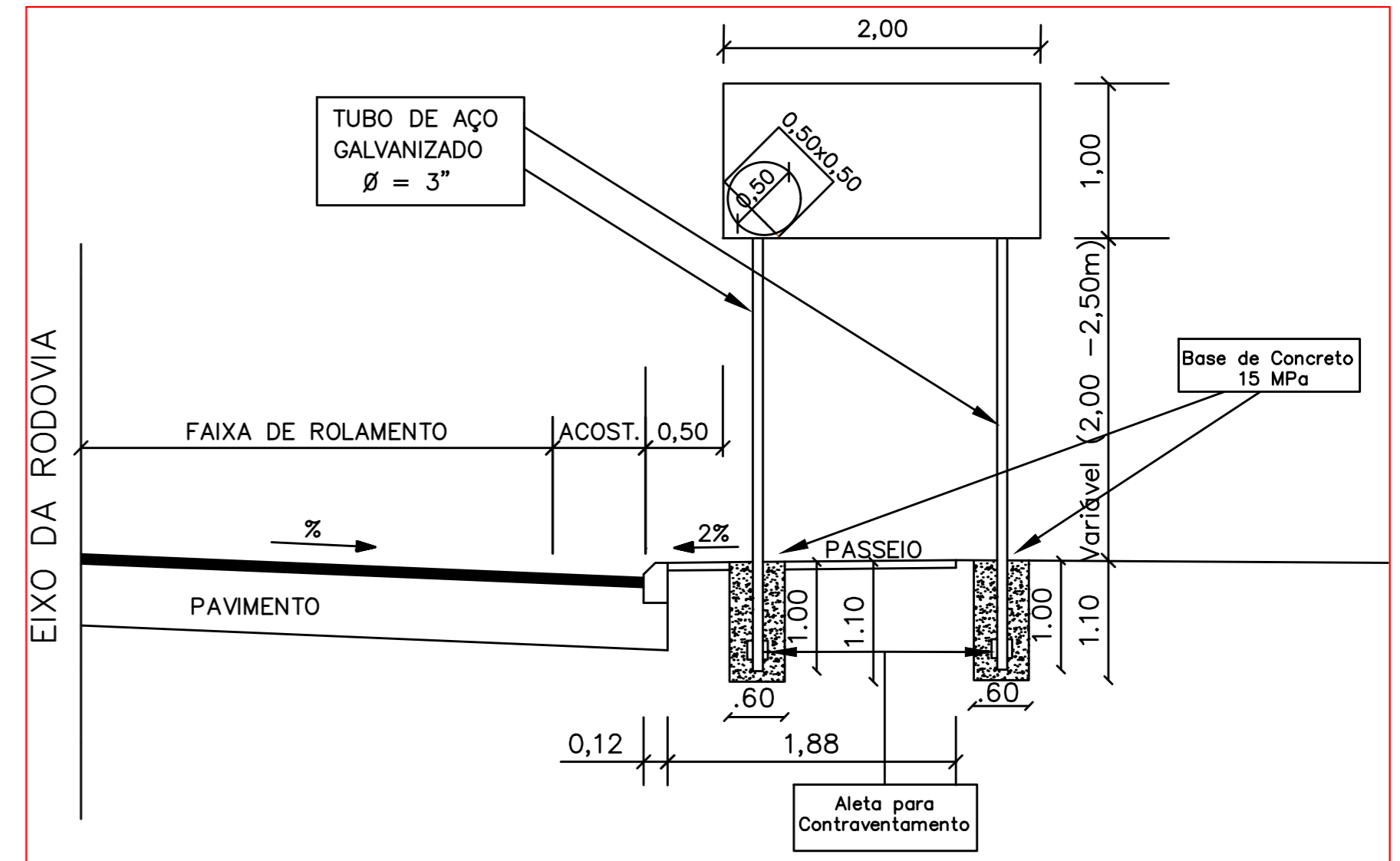

DETALHE DE VALAS

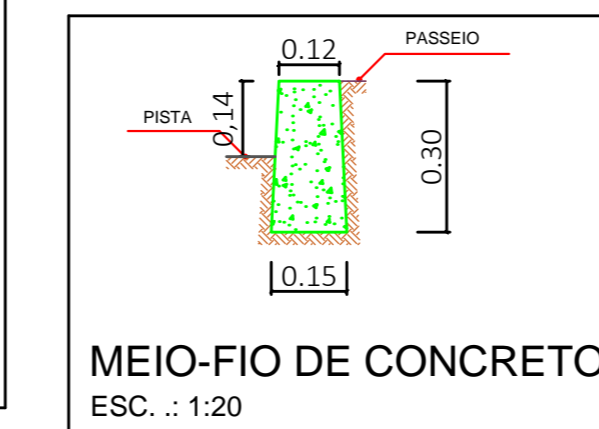
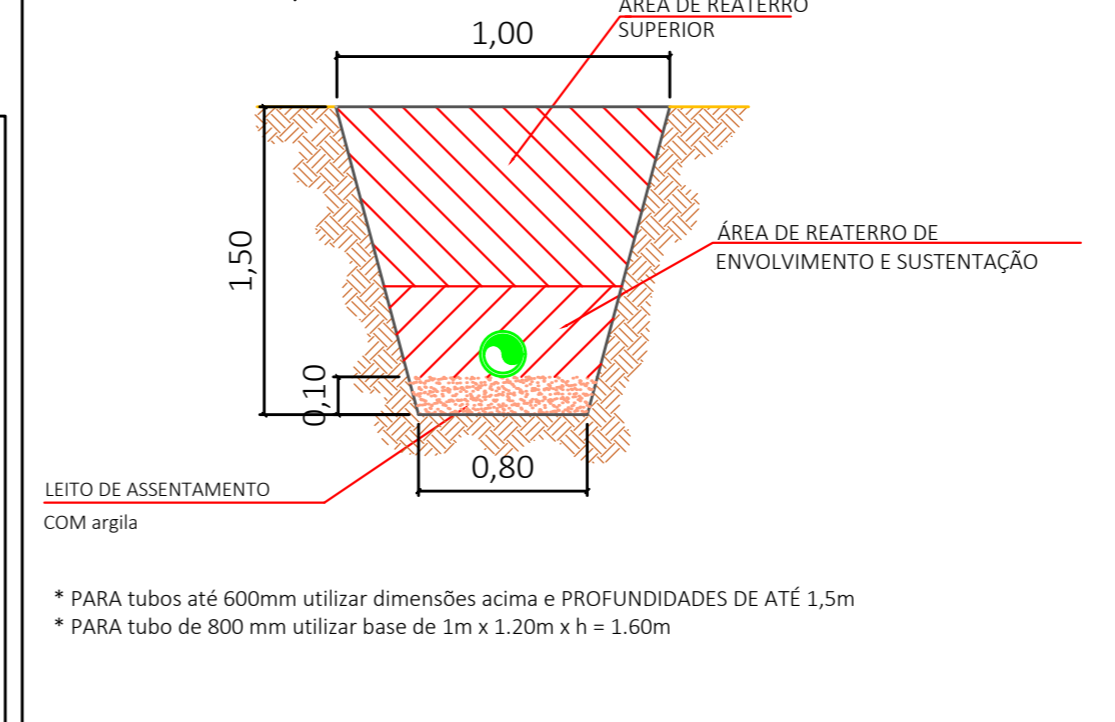

PLANTA BAIXA BOCA-DE-LOBO

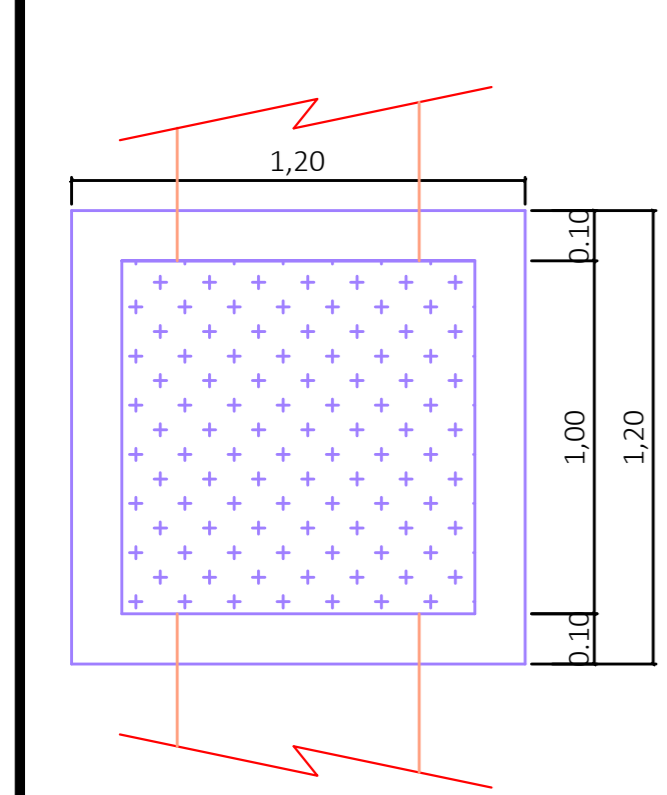

CORTE BOCA-DE-LOBO

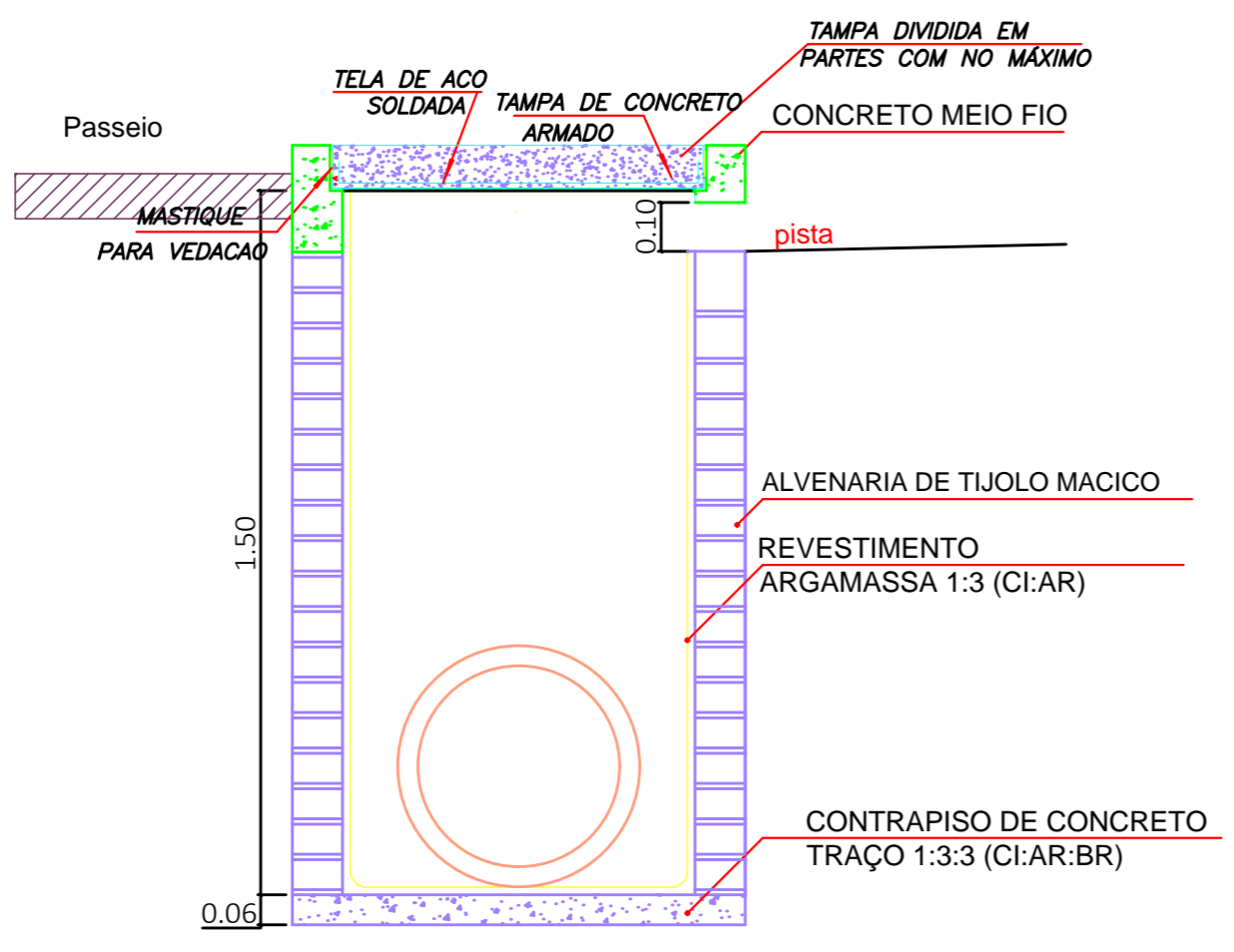

PREFEITURA MUNICIPAL DE NONOAI  
Rua Padre Manoel Gomes Gonzales 99600-000 Nonoai / RS

CAÇAMENTO RUA JULIO GOLIN

DETALHES BOCA DE LOBO, RAMPA DE ACESSIBILIDADE, MEIO FIO E VALA E SINALIZAÇÃO VERT.

Propr.: Pref. Mun. de Nonoai Resp.Téc.: CLEBERSON VALDANO ALIEVI  
Eng.º Civil - CREA-RS 308975-1

Ar. ampliada: 11.917,55m<sup>2</sup> Data: ABRIL/2019 Escala: Prancha: 3/4 Desenho: Cleberston V. Alievi